

HALDEX

Haldex Universal fast Li-ion charger,
Thank you for choosing this Haldex Universal Fast Li-ion
Charger, USB-C port input, world-wided.

1.Package contents

The box of Haldex Universal Fast Li-ion Charger contains:

1. Exchangeable plate (only in kit model)
2. Charger base
3. USB-C to USB-C cable
4. USB-C PD 20W car charger

2.How to use the Haldex Universal Fast Li-ion Charger?

Fix exchangeable plate to the charger base
Connect the PD 20W wall plug charger or 20W PD car charger
which has 12V 1.5A output.

Place the battery onto the charger

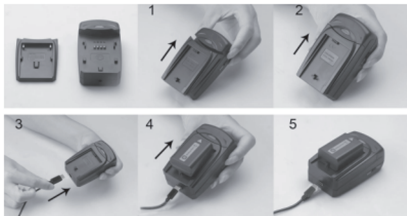

3.Manual

When the charger is plugged in, it automatically turns the
"Status" LED on. The meaning of the indicator lights are as
followed:

The LED is green before the before taking the battery in the
charger.

The LED is red when the battery is charging.

The LED is green when the battery is fully charged.

4.Safety precautions:

Use only compatible power supplies.

Protect the product from heat or water.

Keep the metal contacts always clean.

Always disconnect the plug after charging from the socket.

Don't attempt to open the charger to change the outward form
and or damaging the product.

5.Technical Details:

Input:PD12V 1.5A

Output:DC4.2-8.8V / 0.8A MAX



Haldex Pty Ltd

02 9553 8399 | sales@haldex.com.au | www.haldex.com.au

Made in China